

WiseCable™ Stainless Steel Cable Rail



Push lock threaded eye and lag eye



The push lock threaded eye is an exposed, swageless, non-tensioning, face-of-the-post-mounted fitting that is suitable for use on level or pitched runs and is available for 1/8" diameter 1x19 stainless steel cable.

The push lock threaded eye must be used with a tensioning fitting on the opposite end of the run. This fitting attaches to the end post by installing a lag eye into a pre-drilled and tapped hole in the end post and

attaching the push lock threaded eye to the threaded lag eye with a button head screw. The cable attaches to the fitting via our push lock locking wedge system which requires no special tools. Screw and lag eye are sold separately.

While this fitting can be used on pitched or level runs, it is most appropriate for pitched runs because the threaded eye portion of the fitting pivots at the lag eye.

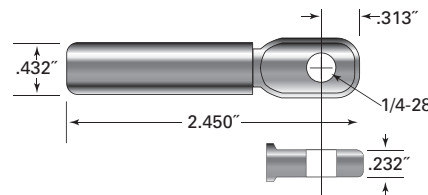
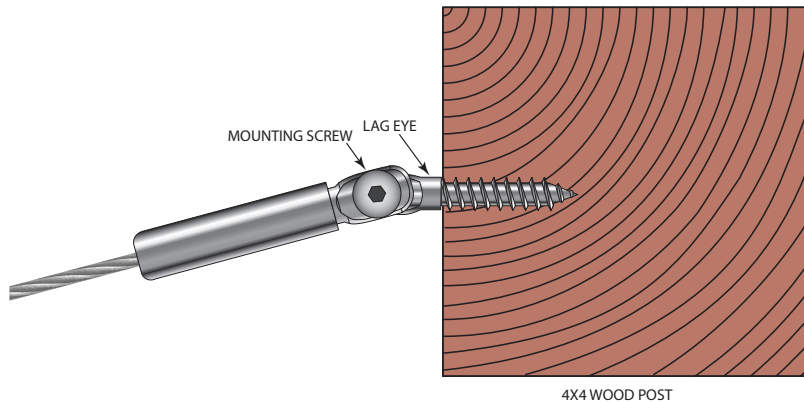

CABLE DIA.	PART NO.	USE WITH SCREW NO.	USE WITH LAG EYE NO.
1/8"	PUSH LOCK/EYE	SC-6	LE-6