

DeckWise® • The Ipe Clip® Fastener Company, LLC • 2111 58th Ave. E, Bradenton, FL 34203
Tel: 941-896-9851 • Toll Free: 866-427-2547 • info@DeckWise.com • www.DeckWise.com



WiseWrap® JoistTape™ is a malleable polyethylene waterproof wood flashing material. It is made of a rubberized asphalt mastic adhesive. Apply to decking joists, around deck support posts and over ledger boards.

INTENDED USES

- Joists
- Posts
- Ledger Boards
- Cut Ends & More!

SURFACE PREPARATION:

All surfaces to receive WiseWrap® JoistTape™ must be clean, dry, and free from oil, grease and debris. Apply only when temperatures are 35°F or warmer. Use construction grade spray adhesive in cold or difficult conditions. Attach with staples if necessary.



STEP 1 - Cut WiseWrap® Joist Tape™ to Length

Unroll enough WiseWrap® JoistTape™ to match the span of the double joist you are covering. Allow for 3/4" of tape overhang on each end. Cut the WiseWrap® JoistTape™ to length. Tape long joist spans before shorter spans.



STEP 2 - Peel Off Backing

Peel off the release liner backing and begin adhering the WiseWrap® JoistTape™ to one end of the joist.



STEP 3 - Apply 2/3 WiseWrap® Joist Tape™

Apply WiseWrap® JoistTape™ 2/3rds on top of the double joist with 1/2" to 3/4" overhanging edge. Overlap at least 1/2" to 3/4" over any joist outside edge or over an existing WiseWrap® JoistTape™ applied. Slightly stretch the WiseWrap® JoistTape™ to avoid wrinkles and press the self-adhesive side down as you move along the length.



STEP 4 - Press JoistTape™ Down

Press the top of tape down firmly to set adhesive. The top of one joist and half of the second joist should be covered.



STEP 5 - Fold Edges Down Over Sides

Press WiseWrap® JoistTape™ down securely over the joist edge. Fold down the remaining 1/3rd overhang. Then, press firmly to adhere the sides. (Staple edge and sides if necessary.)

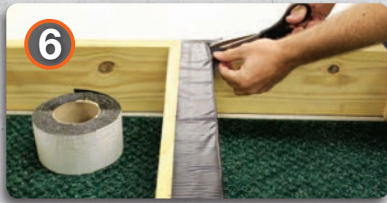

STEP 6 - Trim WiseWrap® Joist Tape™ Inside Corners

Where inside corners exist, cut the WiseWrap® JoistTape™ with scissors and fold the inside down. Overlap tape ends. On outside corners, cut and tuck the corners under itself for a crisp corner.



STEP 7 - Cut WiseWrap® Joist Tape™ To Length

Unroll enough WiseWrap® JoistTape™ to match the span of the double joist you just covered. Allow for 3/4" of tape overhang on each end. Cut the WiseWrap® JoistTape™ to length.



STEP 8 - Apply 2nd JoistTape™ Row

Repeat STEP 3 through STEP 6. Overlap the 1/3rd of tape on the exposed 2nd joist with the new strip.



STEP 9 - Trim WiseWrap® Joist Tape™ Inside Corners

Where inside corners exist, cut the WiseWrap® JoistTape™ with scissors and fold the inside down. Overlap tape ends. On outside corners, cut and tuck the corners under itself for a crisp corner. Cut WiseWrap® JoistTape™ on it's side edges when applied to adjacent joist runs. Then fold edges down.

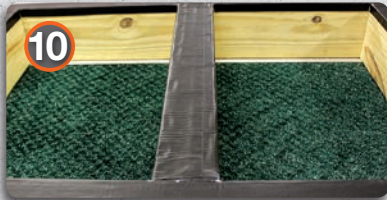

STEP 10 - Smooth Out Tape Surface

Finish by pressing all tops and sides down tightly. Cut and tuck WiseWrap® JoistTape™ around corners where applicable. Use a roller for a smooth flat surface.

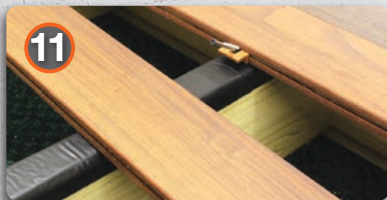

STEP 11 - Install Deck Fasteners

Install Ipe Clip® Hidden Deck Fasteners and other deck fastening methods in their normal manner. WiseWrap® JoistTape™ will seal around penetrating fastening screws and act as a sound dampening membrane.